

Existing Buildings to be demolished
Roof Plan

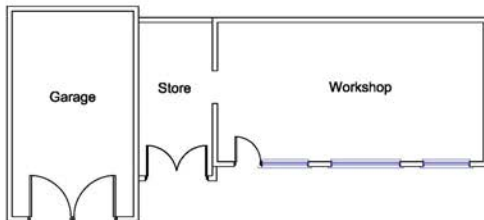

Existing Buildings to be demolished
Floor Plans

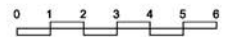

Project : Rear of 102 - 112 High Street Shoeburyness		
Proposed 2 Bed Dwelling		
Drawing : Existing buildings to be demolished		
Scale : 1:100 @A3	Status : Planning	Rev : -
Date : Aug 2014	Dwg No : 336-04	

All measurements to be checked on site prior to commencement.